

Control BreezeGuard by App

Turn on/off remotely when you're not home

Step 1

Search for the **"Smart Life"** app online and click install.



Step 2

1. Please ensure your Wi-Fi frequency band is **2.4 GHz**.
2. With the power off (red light on), press and hold the Wi-Fi button for **5 seconds** until a beep sounds.

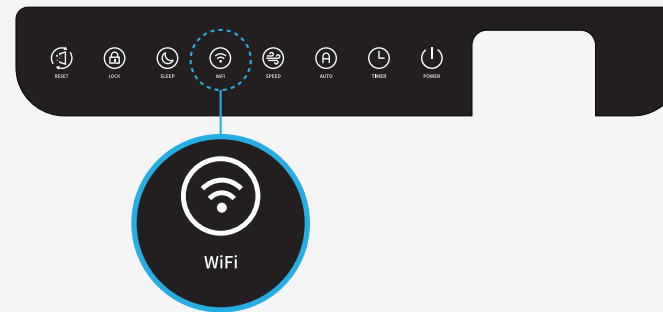

Step 3

1. Keep your phone connected to Wi-Fi **2.4 GHz**.
2. Open the APP and click **"Add Device"** on the app screen.

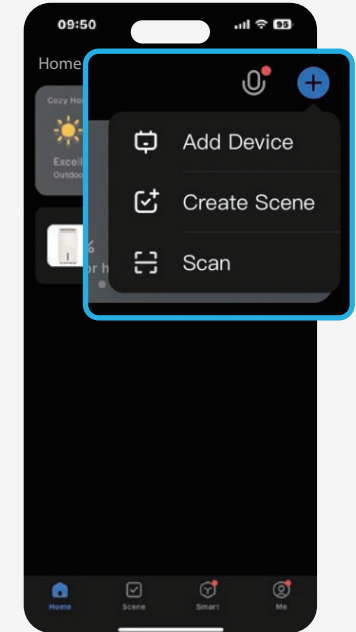

Step 4

1. Wait for the app to search for the device.
2. Once the device is found, please click on it.

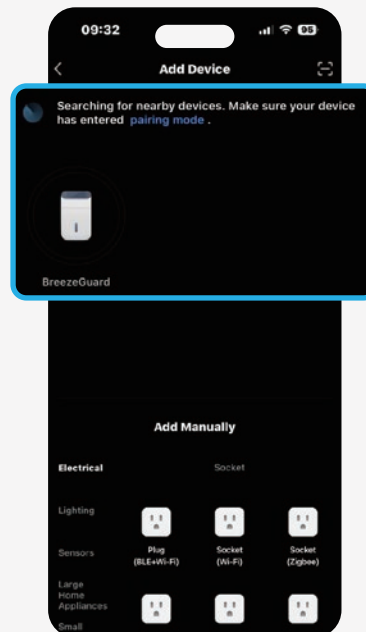

Step 5

1. Enter your Wi-Fi password.
2. Press the **"Next"** button to add the device.

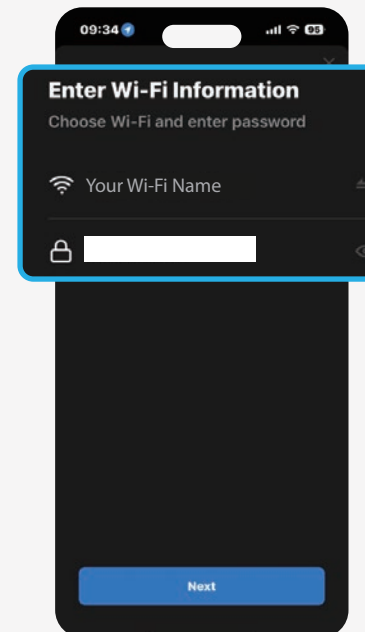

Step 6

Wait for the connection to succeed, and then press **"Done"** button.

